

**Rt 29  
Detour  
EB and WB**

**Country Club/I-10 Closure**  
**Construction begins Sept. 8, 2025**  
**Till 2026**

**Rt 29 Eastbound**

Continue EB on Irvington  
L on Campbell Northbound  
**R on Ajo Way Connector**  
L on Ajo  
R on Country Club  
R on Milber  
R on Bentley Ave  
L on President  
To bus stop.

**Rt 29 Westbound**

L on Forgeus  
L on Ajo  
**R on Ajo Way Connector to  
Kino Pkwy**  
L on Kino Pkwy Southbound  
R on Irvington  
To resume

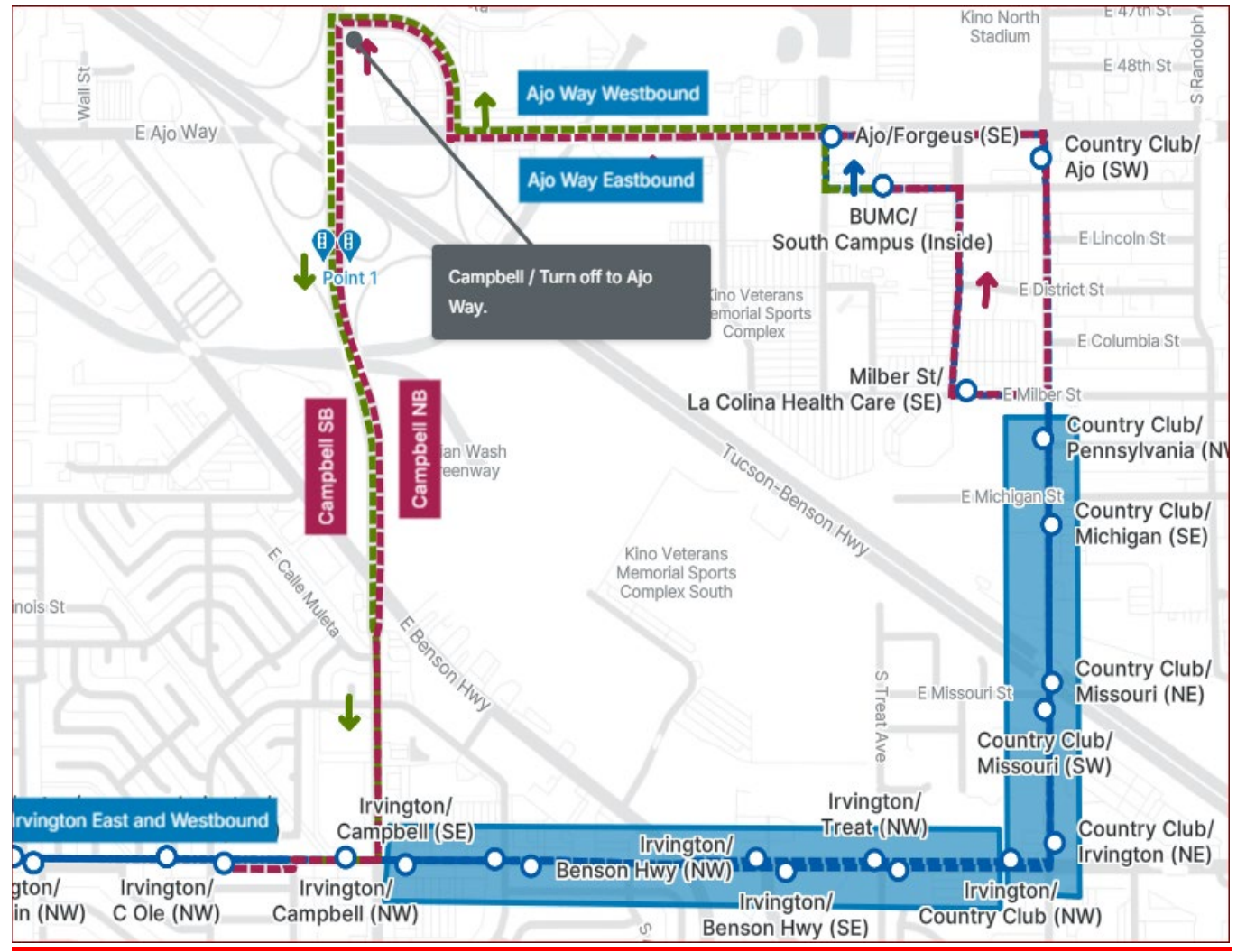

**NOTE: Please service all bus stops on the detour route.**